



Special Design Features

- Self-supported rotary union
- Aluminium anodized housing to resist corrosion from media
- Stainless steel threaded rotor
- Highly precise and lubricated deep groove ball bearings for long life and stable rotation at very high speed
- Specially designed mechanical seals to sustain high pressure changes with minimum friction and wear for prolong service life
- Designed for both axial and radial application
- Available in both US and metric thread standards
- Easy installation

Technical Data

- Max. Pressure 70 bar (1,015 psi)
- Max. Temperature 70°C (160° F)
- Max. Rotor Speed 12,000 rpm
- Max. Flow of Media 80 L / min



NO DRY RUN

FLUIDEN 1016 series coolant rotary unions are ideal for new installations as well as directly interchangeable with any other brands of coolant rotary unions

Axial Model (180°)

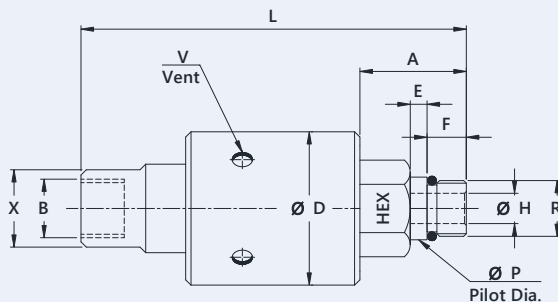

Radial Model (90°)

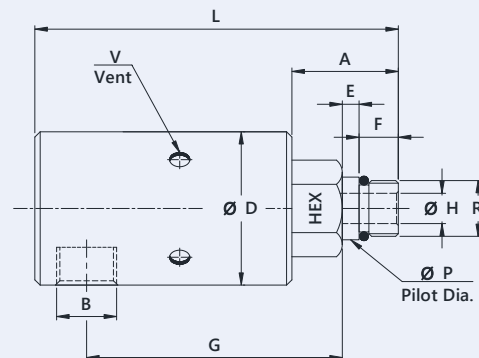

Model No.	'B' Port Size	'R' Rotor Thread	A	F	E	L	G	Ø D	Ø H	Ø P Pilot Dia.	V	HEX	X
1016-110-302	G 3/8" BSP	M 16X1.5 LH	30	11	5	114	----	44	9	17.993/17.975	9	24	22
1016-210-302	3/8" NPT	M 16X1.5 LH	30	11	5	114	----	44	9	17.993/17.975	9	24	22
1016-210-401	3/8" NPT	5/8"-18 UNF RH	33.3	14	4.7	115	----	44	9	16.650/16.644	9	24	22
1016-210-402	3/8" NPT	5/8"-18 UNF LH	33	14	4.7	115	----	44	9	16.650/16.644	9	24	22
1016-108-302	G 1/4" BSP	M 16X1.5 LH	30	11	5	114	----	44	9	17.993/17.975	9	24	22
1016-208-302	1/4" NPT	M 16X1.5 LH	30	11	5	114	----	44	9	17.993/17.975	9	24	22
1016-208-401	G 1/4" NPT	5/8"-18 UNF RH	33.3	14	4.7	115	----	44	9	16.650/16.644	9	24	22
1016-208-402	1/4" NPT	5/8"-18 UNF LH	33.3	14	4.7	115	----	44	9	16.650/16.644	9	24	---
1016-110-392	G 3/8" BSP	M 16X1.5 LH	30	11	5	114	71.3	44	9	17.993/17.975	9	24	---
1016-210-392	3/8" NPT	M 16X1.5 LH	30	11	5	114	71.3	44	9	17.993/17.975	9	24	---
1016-210-491	3/8" NPT	5/8"-18 UNF RH	33.3	14	4.7	115	71.3	44	9	16.650/16.644	9	24	---
1016-210-492	3/8" NPT	5/8"-18 UNF LH	33.3	14	4.7	115	71.3	44	9	16.650/16.644	9	24	---

Subject to technical & dimensional changes without prior notice.

Please do not operate at max. pressure combined with max. speed.

Customized models are available on request.